

JUNE 23, 2016

**NEW ELEMENTARY SCHOOL
AT THOMAS JEFFERSON MIDDLE SCHOOL**

PFRC Meeting

Project Parameters

1. New Elementary School for the Henry Community
2. Support Strategic Plan Goal #4 – Provide Optimal Learning Environments
3. Address capacity by providing 725 seats
4. Open by start of school 2019
5. Multi-story building in northwest corner of site
6. Structured parking
7. Project cost \$59 million

Concept Design

Siting and Massing:

- general building location, shape, size, and height

General site layout and circulation:

- frontage

- bus loop/service access

- pick-up and drop-off

Structured parking:

- rough target on number of parking spots

- play area above parking

June 15, 2016

NEW ELEMENTARY SCHOOL AT THOMAS
JEFFERSON MIDDLE SCHOOL

Massing and Site Update



Scheme 4.2a: “Biscuit”

- 1st floor exterior footprint: 27,828 gsf
- Gym on third floor
- Building slightly cantilevers out as it goes up
- 4 stories
- Linear feet of exterior skin: 3,341 linear feet
- Energy Use Intensity (EUI): 18 kBTU/sf/yr
- Annual energy cost: \$50,201
- Roof space suitable for solar panels: 26,700 sf
- Post energy production EUI: 4



Scheme 4.3a: “Lobster”

- 1st floor exterior footprint: 38,723 gsf
- Gym on ground floor
- Building significantly steps back as it goes up
- Part 3 story, part 4 story
- Linear feet of exterior skin: 3,769 linear feet
- Energy Use Intensity (EUI): 18 kBTU/sf/yr
- Annual energy cost: \$50,652
- Roof space suitable for solar panels: 53,760 sf
- Post energy production EUI: -2.5



Northern-most extent of facades of 4 story building massing in "Biscuit"

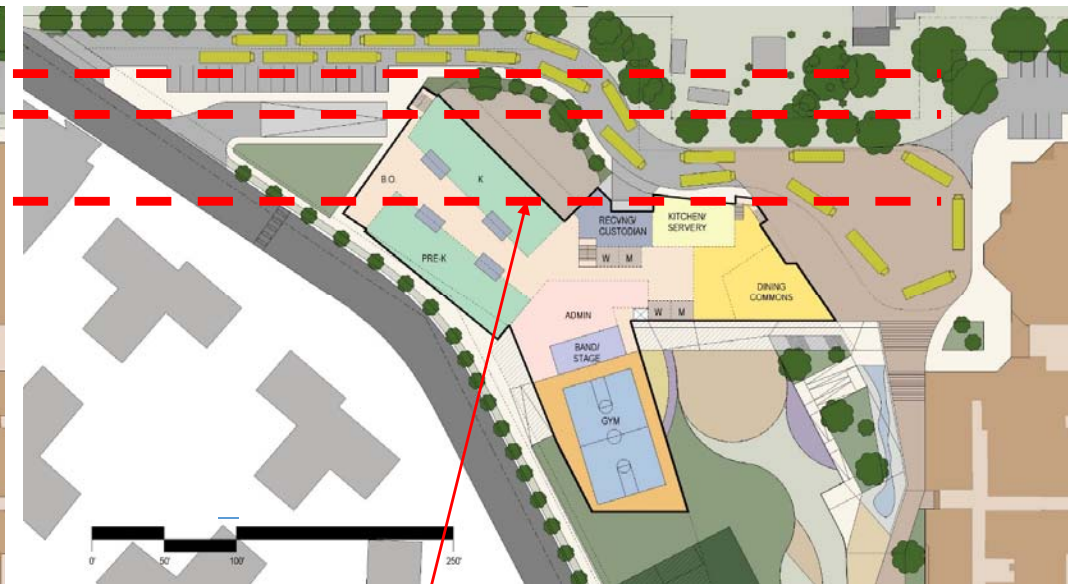
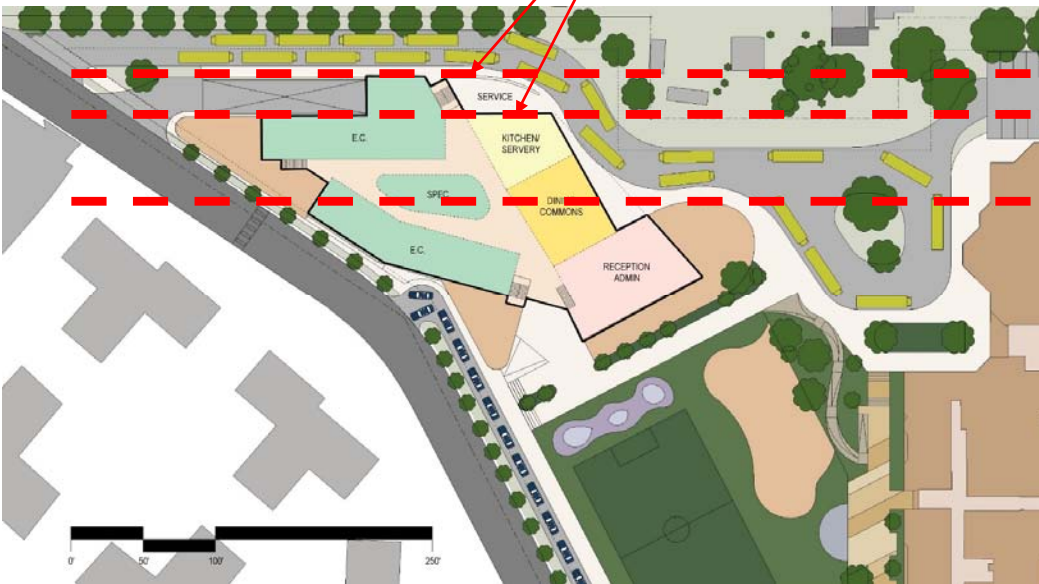

Northern-most extent of facade of 4 story building massing in "Lobster"
80' further south



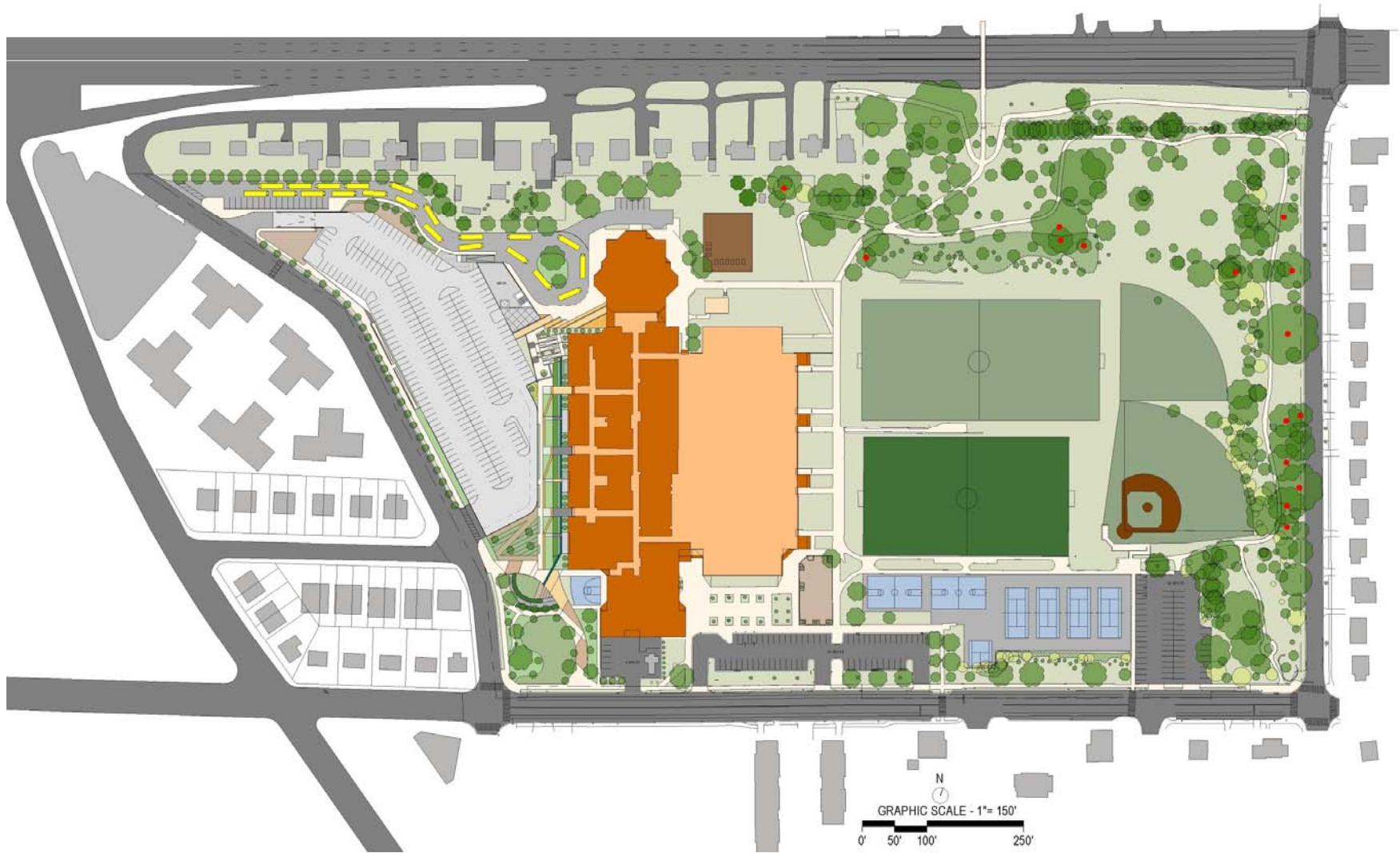

23 June
PFR

9

Scheme 4.3b 225 garage spots, 50 feet between garage and MS

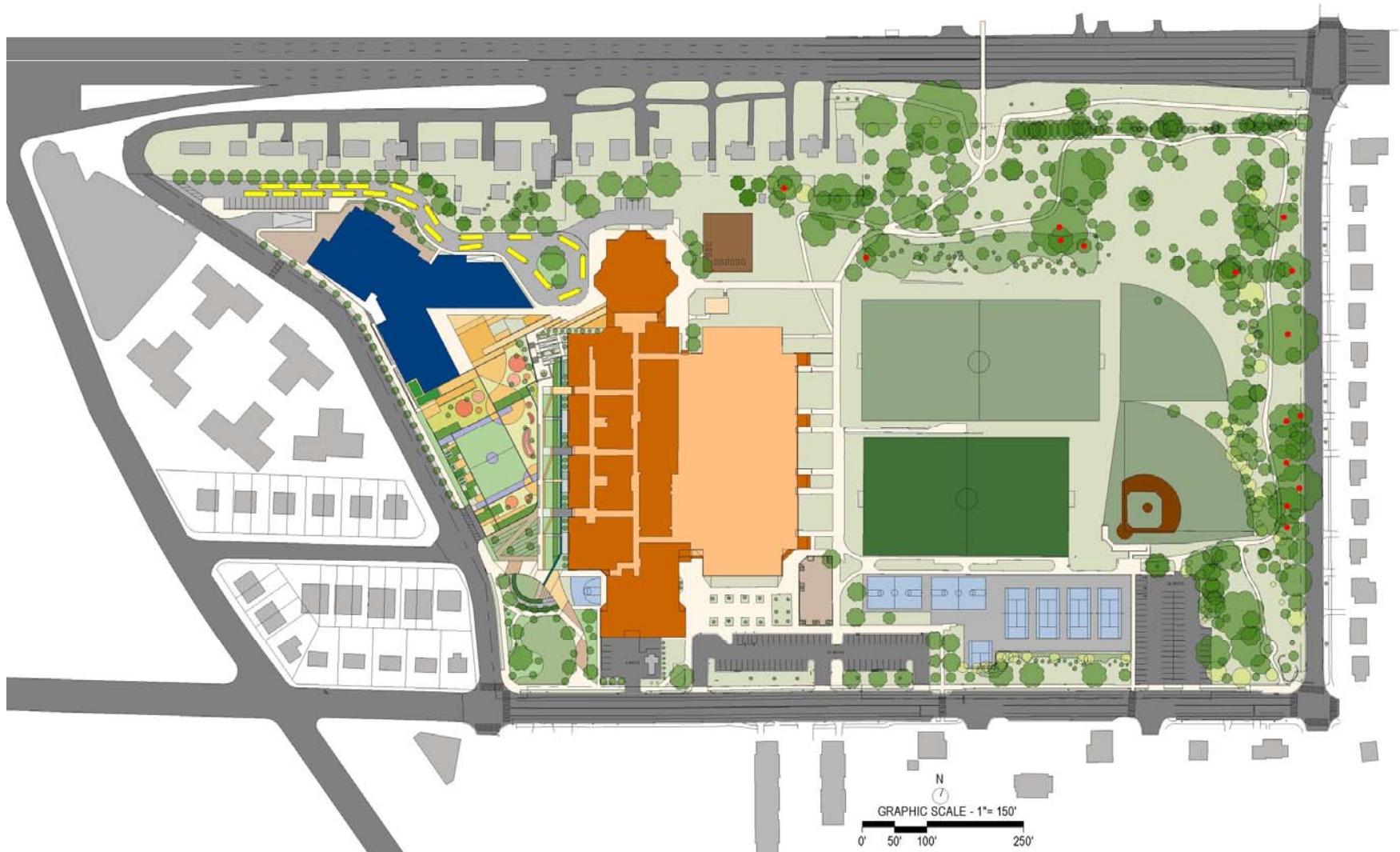











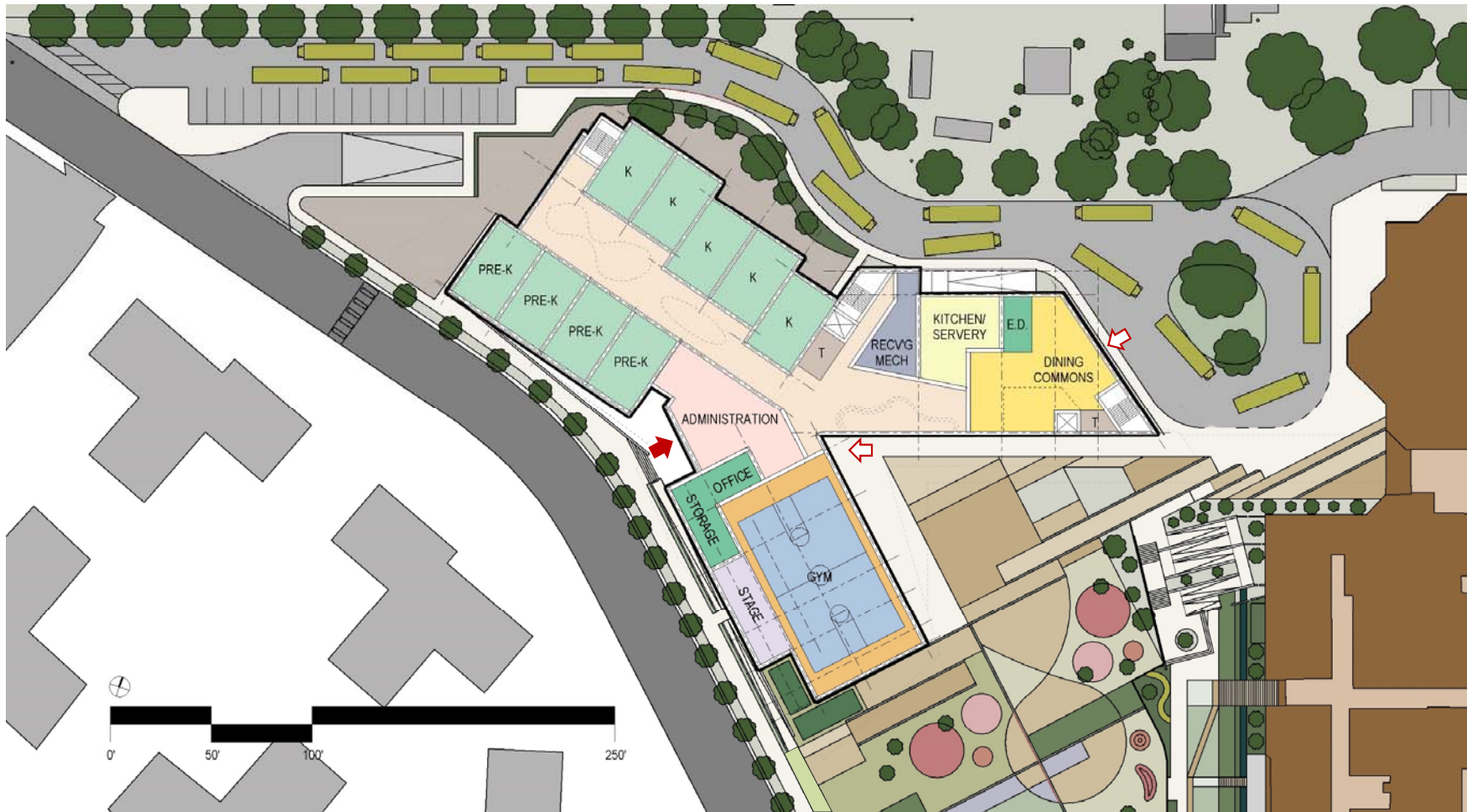













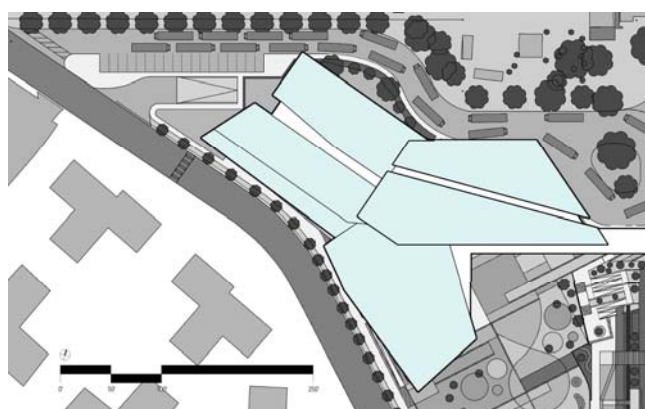
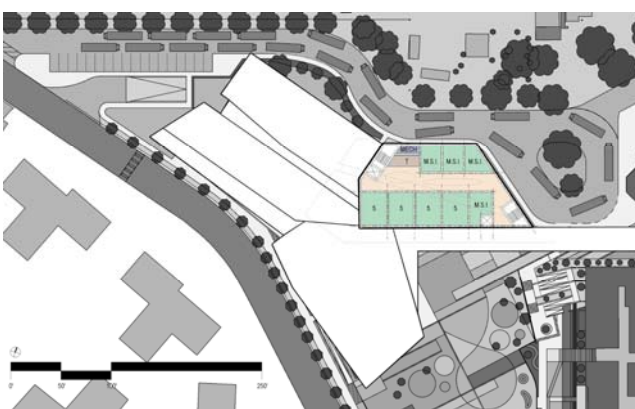
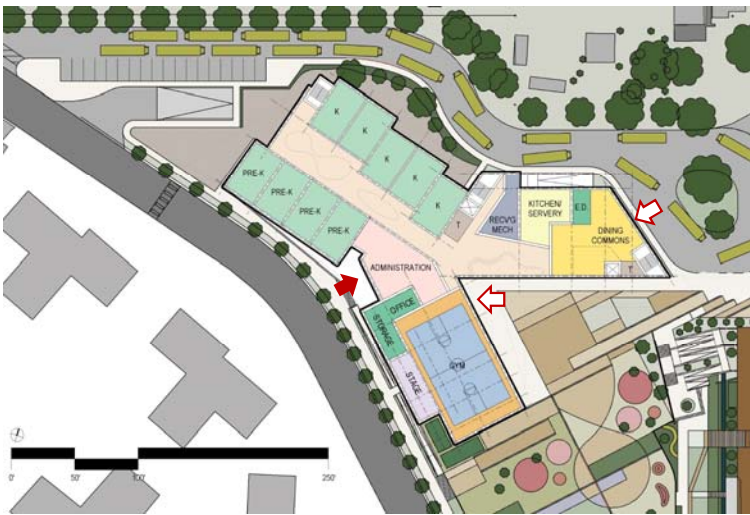



Concept Design

Siting and Massing:

- general building location, shape, size, and height

General site layout and circulation:

- frontage on South Old Glebe

- bus loop/service access on north side of site

- combined pick-up and drop-off within parking garage

Structured parking:

- single level parking structure with maximum amount of parking play area above parking

Discussion

NEXT STEPS

- | | |
|---------|--|
| July 1 | Concept Design to school board (information) |
| July 20 | Concept Design to school board (action) |

ADJORN

For further information please contact:

APS Project Manager

Steve Stricker

571-220-0048

steven.stricker@apsva.us

County Project Manager

Marco Rivero

703-228-3572

mrivero@arlingtonva.us

Web links:

[APS Project Website](#)

[PFRC Project Website](#)

[Submit Public Comment and Sign up for Email Distribution](#)